

CERTIFIED LAND CORNER RECORDATION

DESCRIPTION OF CORNER EVIDENCE FOUND, AND ORIGINAL RECORD (if known)

$\frac{1}{4}$ corner 28/33 , T.16 N., R.63 W.

Found granite stone 9"x7"x4", with $\frac{1}{8}$ chiseled in north side.

DESCRIPTION OF MONUMENT AND ACCESSORIES ESTABLISHED
TO PERPETUATE THE ORIGINAL LOCATION OF THIS CORNER:

Set $\frac{3}{4}$ " iron pin, left stone as memorial.

Referreances: set $\frac{1}{2}$ " iron pipes, northeasterly and northwesterly. (See sketch)

SKETCH, WITH COURSE AND DISTANCE TO ADJACENT CORNER IF DETERMINED IN THIS SURVEY.
(May Sketch or Paste Reproduction on Reverse Side.)

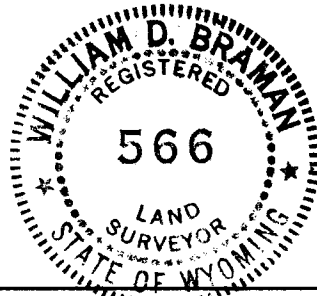
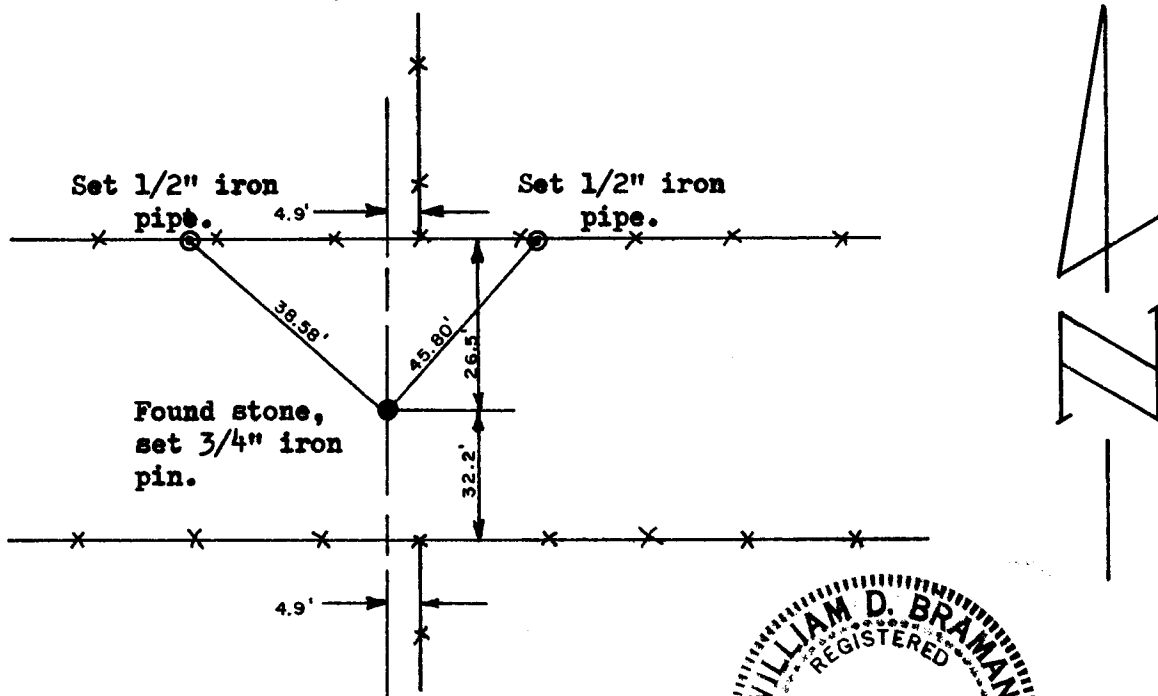

I, William D. Braman certify that I have carefully performed or reviewed the work done on the diagrammed corner as reported on this recordation form and approve the same.

William D. Braman LS 566
Signature of Surveyor Registration No.

STATE OF WYOMING,
Office of Clerk and Recorder,
County of Sarassee

This "corner record" was filed for record on the 18 day of Feb., 1977, was noted on the cross-index plat and is assigned page No. _____, in book No. _____.

James C. Whithead
County Official

Cross Index No.	T. _____	R. _____	Mer.
	<u>V-11</u>	<u>16</u>	<u>63</u> Mer.
	_____	_____	Mer.
	_____	_____	Mer.
	_____	_____	Mer.
	_____	_____	Mer.
	_____	_____	Mer.

V-11 16-63